

80 SERIES

Medium-Heavy Duty
Industrial

Load Capacity: 350 to 1000 lbs.

Quality Features

- FOUR-SIDED, DOUBLE BALL RACEWAY.**
 Hardened steel ball bearings in the load bearing and secondary thrust bearings touch the swivel raceway "on all four sides." This protects the central king pin from shock loading for free swiveling under heavy loads.
- HEAT-TREATED MOVING PARTS.**
 All moving parts are heat treated to a precise molecular depth and Rockwell hardness. This extends caster life under rugged conditions and shock loads.
- TWO-PIECE RIGID CASTER.**
 Rigid caster utilizes a welded top plate and yoke design instead of a one-piece stamped yoke as used on competitive brands.
- THREAD GUARDS.**
 Available on most wheels, keeps unwanted materials out of the wheel bearings thus increasing the life of the caster.



SWIVEL



RIGID

Options

- Cart Washable Grease Seals
- Maintenance Free Swivel Bearings
- High-Temperature Wheels
- Conductive or Static-Dissipative Wheels
- Gray, Non-Marking Wheels
- Powder Coated Finishes

FOUR SIDED DOUBLE BALL BEARING RACEWAY 80 SERIES

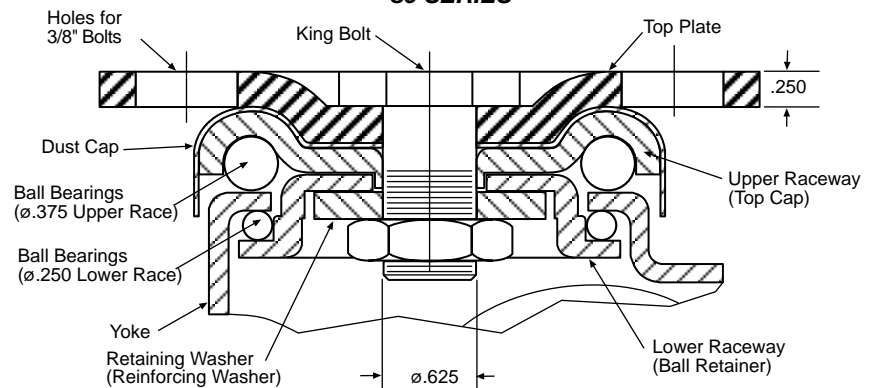

Wheel Selection

ADVANCED ELASTOMER

NEOPRENE RUBBER

HI-CAP NEOPRENE

HARD RUBBER

STEEL DISC

MOLD-ON POLYURETHANE



TOP PLATE

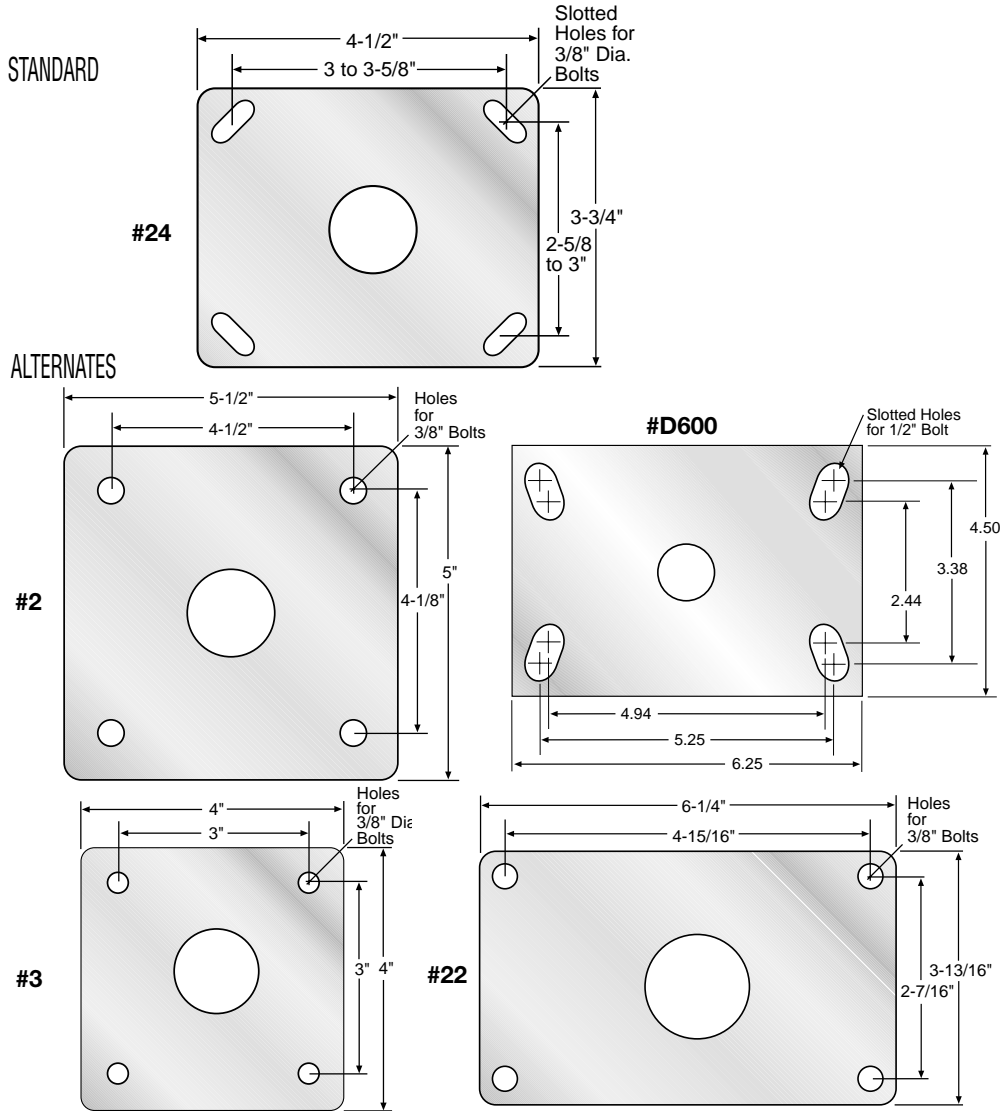

STEMS

"O" STEM TABLE

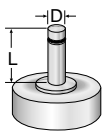

| Dimension D | Dimension L | Stem Number |
|-------------|-------------|-------------|
| *5/8" | 2" | O80-58-2 |
| *3/4" | 2" | O80-34-2 |
| *7/8" | 2" | O80-78-2 |
| 1" | 2-1/2" | O80-1-212 |

Other stem sizes and dimensions available.
*Special Order/Minimum Quantity

"L" STEM TABLE

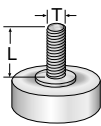

| Dimension T | Dimension L | Stem Number |
|-------------|-------------|--------------|
| 5/8"-11 | 2-1/2" | L80-5811-212 |
| 3/4"-10 | 2-1/2" | L80-3410-212 |
| *7/8"-9 | 2-1/2" | L80-789-212 |
| *1"-8 | 2-1/2" | L80-18-212 |

Other stem sizes and dimensions available.
*Special Order/Minimum Quantity

**7/8" round" stem

"LP" stem

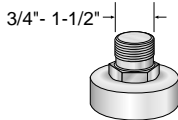

"LPC" stem

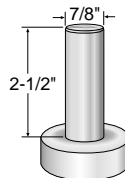
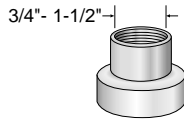

Subtract .250" from overall height for stem casters.

POLYOLEFIN HUB

POLYURETHANE

THERMO PLASTIC RUBBER

PHENOLIC

POLYOLEFIN

CAST IRON

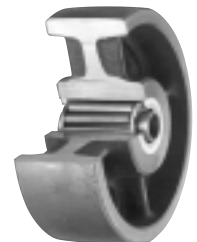
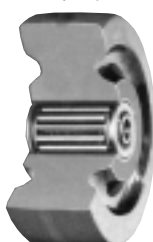

Hub Brake

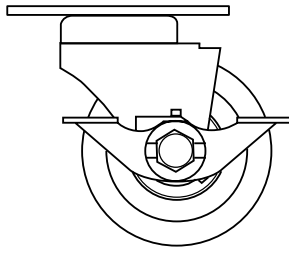

Hub Brake

Prevents wheel movement by engaging fork legs against wheel hub when foot pedal is applied in the locked position.

Four Position Swivel Lock (SL)

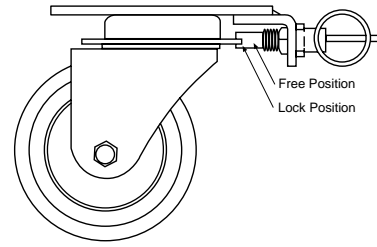

Four Position Swivel Lock

A horizontal four position swivel lock with a springloaded plunger to securely hold the swivel in the slotted position desired. Plunger can be put into a neutral position for free swiveling action.

Heavy Duty Combination Swivel & Wheel Brake (CB)

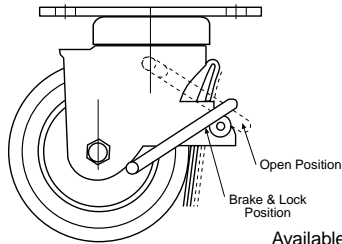

Available in 5", 6", & 8"

Combination Four Position Swivel Lock & Wheel Brake (WB-SL)

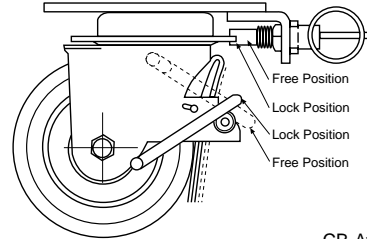

CB Available in 5", 6", & 8"

Heavy Duty Combination Swivel & Wheel Brake

This combination swivel and wheel brake was especially designed for heavy equipment that must be made immobile. The wheel brake is constructed to operate in conjunction with the swivel. The overall height of this caster with the brake applied or released remains the same, even when used with companion casters as a swivel or rigid.

Combination Four Position Swivel Lock & Wheel Brake

This combination horizontal four position swivel lock and wheel brake was designed to work together or operate independent from one another. Both the swivel lock plunger and the wheel brake operate from a spring steel action to assure a positive operation.

40

| Diameter | Tread Width | Load Capacity | Wheel Material | Bearing | Swivel Part Number | Rigid Part Number | Approx. Weight | Overall Height | Swivel Radius | |
|----------|-------------------------------|----------------|------------------------------|-----------------|----------------------------------|-------------------|-------------------|----------------|---------------|--------------------|
| 3 | 1 13/16 | 500 | POLYOLEFIN | ROLLER | 83-24-TPO | 83-24-TRPO | 4-1/2 | 4-1/2 | 2-5/8 | |
| | | 350 | NEOPRENE RUBBER | ROLLER | 83-24-TDN | 83-24-TRDN | 5 | | | |
| | 2 | 440 | HI-CAP NEOPRENE | ROLLER | 83-24-TKN | 83-24-TRKN | 5 | | | |
| | | 800 | HARD RUBBER | ROLLER | 83-24-TH | 83-24-TRH | 5-1/2 | | | |
| | | | POLYURETHANE / CAST IRON HUB | ROLLER | 83-24-TADI-M-CI | 83-24-TRADI-M-CI | 5-1/2 | | | |
| | | 900 | ADVANCED ELASTOMER | DELTRIN | 83-24-DAE | 83-24-DRAE | 5 | | | |
| | | | | PRECISION BALL | 83-24-PXAE | 83-24-PXRAE | 5 | | | |
| | | 1000 | CAST IRON | ROLLER | 83-24-TCI | 83-24-TRCI | 5-1/2 | | | |
| | | | PHENOLIC | ROLLER | 83-24-TPR | 83-24-TRPR | 5 | | | |
| | | 4 | 2 | 200 | EXTRA SOFT THERMO-PLASTIC RUBBER | DELTRIN | 84-24-DPD-M-PO-55 | | | 84-24-DRPD-M-PO-55 |
| ROLLER | 84-24-TPD-M-PO-55 | | | | 84-24-TRPD-M-PO-55 | | | | | |
| 350 | NEOPRENE RUBBER | | | ROLLER | 84-24-TDN | 84-24-TRDN | | | | |
| 410 | THERMO-PLASTIC RUBBER | | | DELTRIN | 84-24-DPD-M-PO | 84-24-DRPD-M-PO | | | | |
| ROLLER | 84-24-TPD-M-PO | | | 84-24-TRPD-M-PO | | | | | | |
| 440 | HI-CAP NEOPRENE | | | ROLLER | 84-24-TKN | 84-24-TRKN | | | | |
| 600 | POLYURETHANE / POLYOLEFIN HUB | | | DELTRIN | 84-24-DADI-M-PO | 84-24-DRADI-M-PO | | | | |
| 700 | POLYOLEFIN | | | ROLLER | 84-24-TPO | 84-24-TRPO | | | | |
| 750 | POLYURETHANE / POLYOLEFIN HUB | | | ROLLER | 84-24-TADI-M-PO | 84-24-TRADI-M-PO | | | | |
| | HARD RUBBER | | | ROLLER | 84-24-TH | 84-24-TRH | | | | |
| 800 | POLYURETHANE / CAST IRON HUB | | | ROLLER | 84-24-TADI-M-CI | 84-24-TRADI-M-CI | 8-3/4 | | | |
| | | | | 8-3/4 | | | | | | |
| 1000 | ADVANCED ELASTOMER | | | BALL | 84-24-XAE | 84-24-XRAE | 6-1/2 | | | |
| | | | | DELTRIN | 84-24-DAE | 84-24-DRAE | | | | |
| | | PRECISION BALL | 84-24-PXAE | 84-24-PXRAE | | | | | | |
| | | ROLLER | 84-24-TAE | 84-24-TRAE | | | | | | |
| | | ROLLER | 84-24-TCI | 84-24-TRCI | | | | | | |
| | | ROLLER | 84-24-TPR | 84-24-TRPR | 7 | | | | | |

80 Series continued

| Diameter | Tread Width | Load Capacity | Wheel Material | Bearing | Swivel Part Number | Rigid Part Number | Approx. Weight | Overall Height | Swivel Radius |
|--------------------|--------------------|-------------------------------|----------------------------------|-------------------|--------------------|--------------------|----------------|----------------|---------------|
| | | | | | | | | | |
| 5 | 1 9/16 | 550 | STEEL DISC POLYURETHANE | ROLLER | 85-24-TADI-T-SD | 85-24-TRADI-T-SD | 7 | 6-5/8 | 4-1/8 |
| | | 225 | EXTRA SOFT THERMO-PLASTIC RUBBER | DELRIN | 85-24-DPD-M-PO-55 | 85-24-DRPD-M-PO-55 | | | |
| | 350 | NEOPRENE RUBBER | ROLLER | 85-24-TPD-M-PO-55 | 85-24-TRPD-M-PO-55 | | | | |
| | 440 | STEEL DISC NEOPRENE | ROLLER | 85-24-TDN | 85-24-TRDN | | | | |
| | | STEEL DISC HI-CAP NEOPRENE | ROLLER | 85-24-TDN-T-SD | 85-24-TRDN-T-SD | | | | |
| | | HI-CAP NEOPRENE | ROLLER | 85-24-TKN | 85-24-TRKN | | | | |
| | | STEEL DISC HI-CAP NEOPRENE | ROLLER | 85-24-TKN-T-SD | 85-24-TRKN-T-SD | | | | |
| | 800 | THERMO-PLASTIC RUBBER | DELRIN | 85-24-DPD-M-PO | 85-24-DRPD-M-PO | | | | |
| | | HARD RUBBER | ROLLER | 85-24-TPD-M-PO | 85-24-TRPD-M-PO | | | | |
| | | POLYOLEFIN | ROLLER | 85-24-TH | 85-24-TRH | | | | |
| | | POLYURETHANE / CAST IRON HUB | ROLLER | 85-24-TPO | 85-24-TRPO | | | | |
| | 900 | POLYURETHANE / CAST IRON HUB | ROLLER | 85-24-TADI-M-CI | 85-24-TRADI-M-CI | | | | |
| | | | TAPERED ROLLER | 85-24-YADI-M-CI | 85-24-YRADI-M-CI | | | | |
| | | POLYURETHANE / POLYOLEFIN HUB | DELRIN | 85-24-DADI-M-PO | 85-24-DRADI-M-PO | | | | |
| | | | ROLLER | 85-24-TADI-M-PO | 85-24-TRADI-M-PO | | | | |
| | | | BALL | 85-24-XAE | 85-24-XRAE | | | | |
| DELRIN | | | 85-24-DAE | 85-24-DRAE | | | | | |
| 1000 | ADVANCED ELASTOMER | PRECISION BALL | 85-24-PXAE | 85-24-PXRAE | | | | | |
| | CAST IRON | ROLLER | 85-24-TAE | 85-24-TRAE | | | | | |
| 1000 | CAST IRON | ROLLER | 85-24-TCI | 85-24-TRCI | | | | | |
| | PHENOLIC | ROLLER | 85-24-TPR | 85-24-TRPR | | | | | |
| 6 | 1 9/16 | 550 | STEEL DISC POLYURETHANE | ROLLER | 86-24-TADI-T-SD | 86-24-TRADI-T-SD | 7-3/4 | 7-1/2 | 4-5/8 |
| | | 250 | EXTRA SOFT THERMO-PLASTIC RUBBER | DELRIN | 86-24-DPD-M-PO-55 | 86-24-DRPD-M-PO-55 | | | |
| | 350 | NEOPRENE RUBBER | ROLLER | 86-24-TPD-M-PO-55 | 86-24-TRPD-M-PO-55 | | | | |
| | 400 | STEEL DISC NEOPRENE | ROLLER | 86-24-TDN-T-SD | 86-24-TRDN-T-SD | | | | |
| | 440 | NEOPRENE RUBBER | ROLLER | 86-24-TDN | 86-24-TRDN | | | | |
| | | STEEL DISC HI-CAP NEOPRENE | ROLLER | 86-24-TKN-T-SD | 86-24-TRKN-T-SD | | | | |
| | 500 | THERMO-PLASTIC RUBBER | DELRIN | 86-24-DPD-M-PO | 86-24-DRPD-M-PO | | | | |
| | | HI-CAP NEOPRENE | ROLLER | 86-24-TPD-M-PO | 86-24-TRPD-M-PO | | | | |
| | 800 | HARD RUBBER | ROLLER | 86-24-TKN | 86-24-TRKN | | | | |
| | | POLYURETHANE / CAST IRON HUB | ROLLER | 86-24-TH | 86-24-TRH | | | | |
| | 840 | POLYOLEFIN | ROLLER | 86-24-TPO | 86-24-TRPO | | | | |
| | | POLYURETHANE / CAST IRON HUB | ROLLER | 86-24-TADI-M-CI | 86-24-TRADI-M-CI | | | | |
| | 900 | POLYURETHANE / POLYOLEFIN HUB | DELRIN | 86-24-DADI-M-PO | 86-24-DRADI-M-PO | | | | |
| | | | ROLLER | 86-24-TADI-M-PO | 86-24-TRADI-M-PO | | | | |
| | | 1000 | ADVANCED ELASTOMER | BALL | 86-24-XAE | 86-24-XRAE | | | |
| | | | ADVANCED ELASTOMER | DELRIN | 86-24-DAE | 86-24-DRAE | | | |
| ADVANCED ELASTOMER | | | PRECISION BALL | 86-24-PXAE | 86-24-PXRAE | | | | |
| ADVANCED ELASTOMER | | | ROLLER | 86-24-TAE | 86-24-TRAE | | | | |
| CAST IRON | ROLLER | 86-24-TCI | 86-24-TRCI | | | | | | |
| PHENOLIC | ROLLER | 86-24-TPR | 86-24-TRPR | | | | | | |
| 8 | 2 | 300 | EXTRA SOFT THERMO-PLASTIC RUBBER | DELRIN | 88-24-DPD-M-PO-55 | 88-24-DRPD-M-PO-55 | 9-3/4 | 9-3/4 | 5-3/4 |
| | | | THERMO-PLASTIC RUBBER | ROLLER | 88-24-TPD-M-PO-55 | 88-24-TRPD-M-PO-55 | | | |
| | 410 | THERMO-PLASTIC RUBBER | DELRIN | 88-24-TPD-M-PO | 88-24-TRPD-M-PO | | | | |
| | | NEOPRENE RUBBER | ROLLER | 88-24-TDN | 88-24-TRDN | | | | |
| | 475 | HARD RUBBER | ROLLER | 88-24-TH | 88-24-TRH | | | | |
| | | | POLYURETHANE / CAST IRON HUB | ROLLER | 88-24-TADI-M-CI | 88-24-TRADI-M-CI | | | |
| | 800 | POLYURETHANE / CAST IRON HUB | ROLLER | 88-24-TADI-M-CI | 88-24-TRADI-M-CI | | | | |
| | | | TAPERED ROLLER | 88-24-YADI-M-CI | 88-24-YRADI-M-CI | | | | |
| | 900 | POLYOLEFIN | ROLLER | 88-24-TPO | 88-24-TRPO | | | | |
| | | | CAST IRON | ROLLER | 88-24-TPR | 88-24-TRPR | | | |
| | 1000 | PHENOLIC | ROLLER | 88-24-TCI | 88-24-TRCI | | | | |
| | | | POLYURETHANE / POLYOLEFIN HUB | ROLLER | 88-24-TPR | 88-24-TRPR | | | |
| 1200 | ADVANCED ELASTOMER | DELRIN | 88-24-DADI-M-PO | 88-24-DRADI-M-PO | | | | | |
| | | ROLLER | 88-24-TADI-M-PO | 88-24-TRADI-M-PO | | | | | |
| | | BALL | 88-24-XAE | 88-24-XRAE | | | | | |
| | | DELRIN | 88-24-DAE | 88-24-DRAE | | | | | |
| 1200 | ADVANCED ELASTOMER | PRECISION BALL | 88-24-PXAE | 88-24-PXRAE | | | | | |
| | | ROLLER | 88-24-TAE | 88-24-TRAE | | | | | |